

MAX 24"

MIN. 8" HIGH

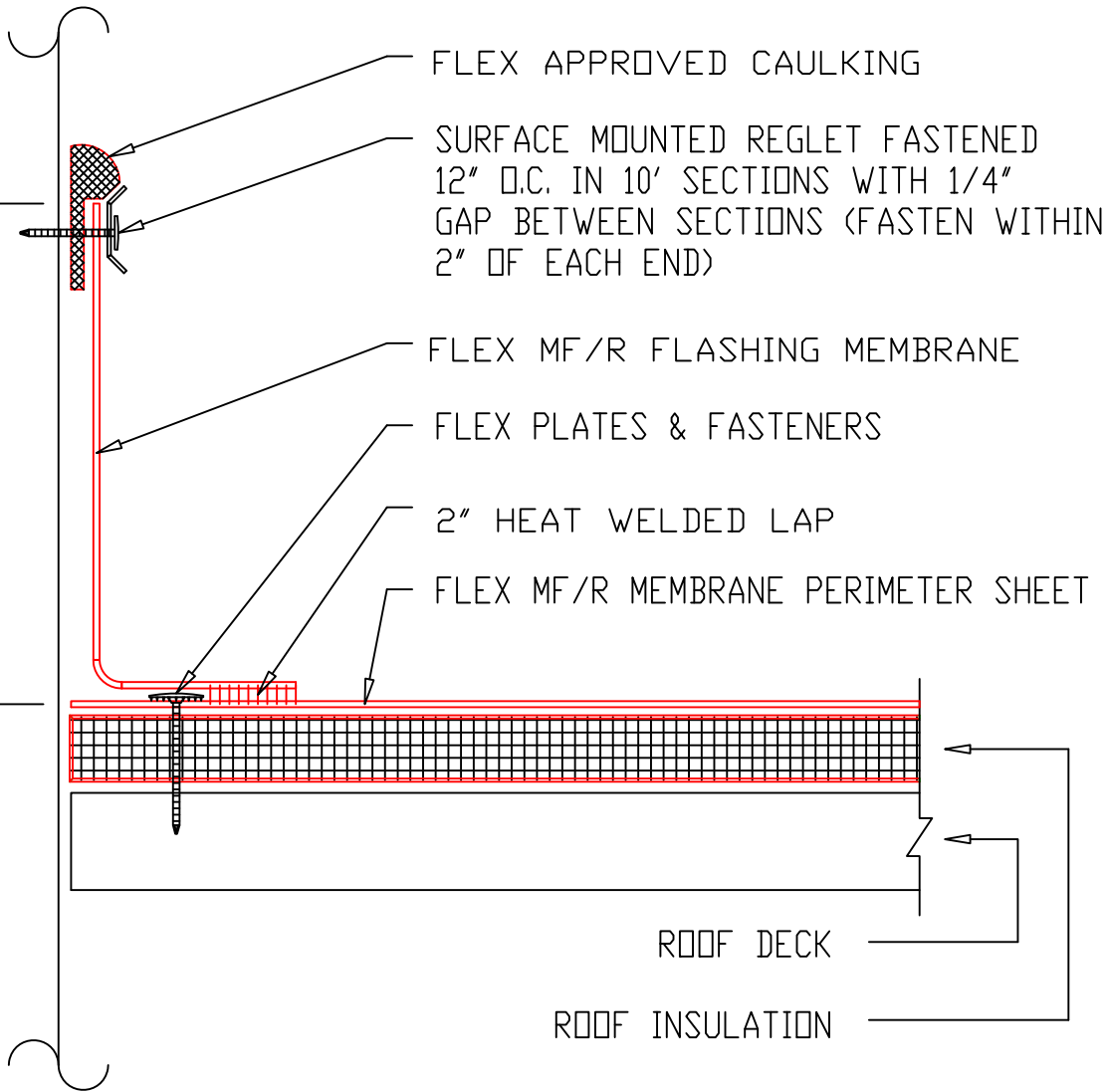

NOTES

REGLET SLIP JOINTS COVERS MUST BE USED WITH THE SURFACE MOUNTED REGLET

TITLE		WALL FLASHING SURFACE MOUNTED REGLET	
NAME		DETAIL NO. 2.10	
DRAWN BY:	KF	DATE:	07/2007
APPLICABLE TO ALL FLEX			
MECHANICALLY FASTENED SYSTEMS			
FLEX MEMBRANE INTERNATIONAL		2670 LEISCZ'S BRIDGE RD. LEESPORT, PA 19533 800-969-0108 www.flexmembranes.com	