

---

FLEX TPO PLUS MECHANICALLY FASTENED ROOFING SYSTEM

---

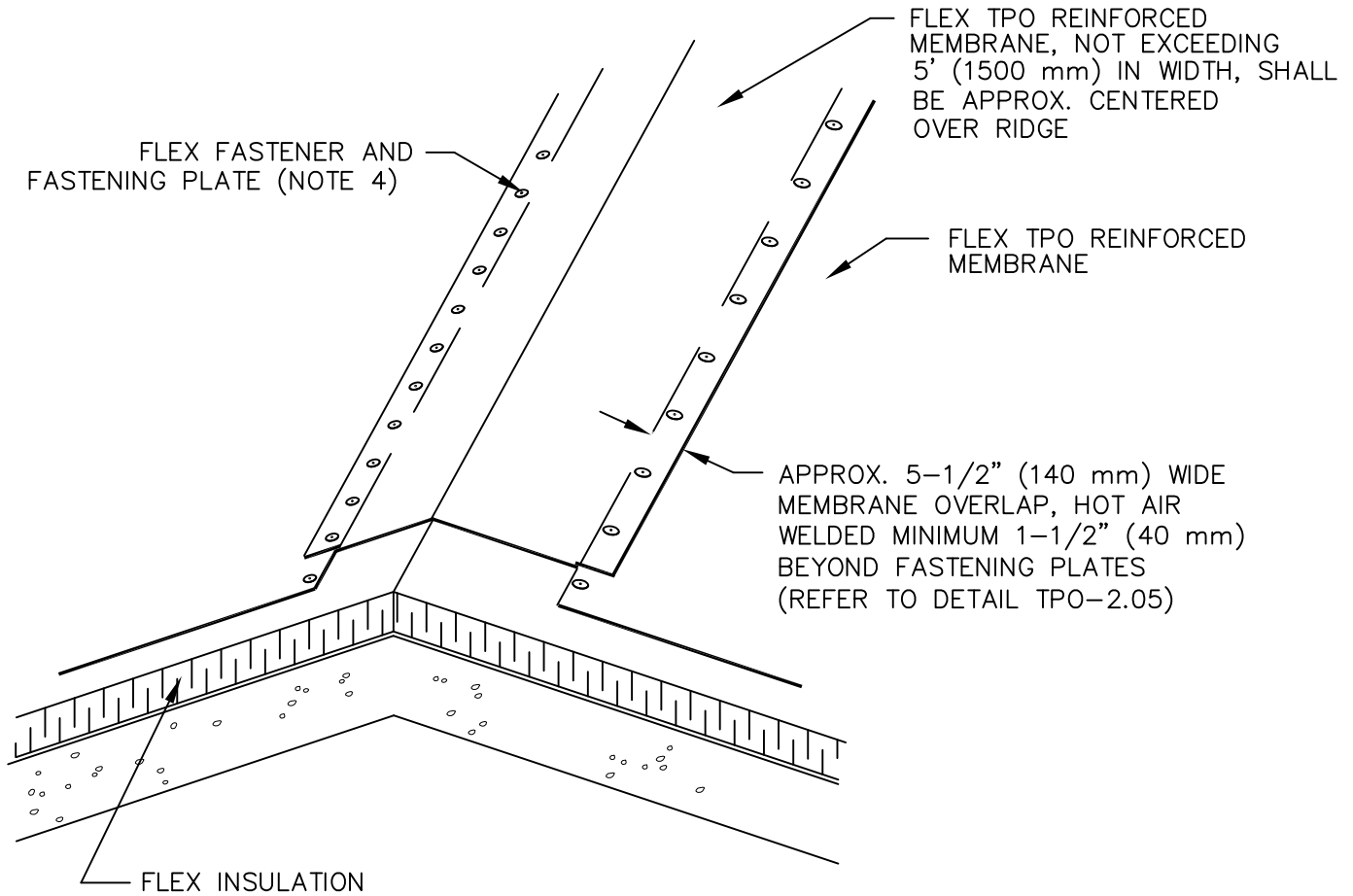

NOTES

1. RIDGE MEMBRANE ATTACHMENT IS ONLY REQUIRED WHEN ROOF SLOPE EXCEEDS 1" (75 mm) TO ONE HORIZONTAL FOOT.
2. POSITION FASTENING PLATES 1/2" (13 mm) MINIMUM TO 1" (25 mm) MAXIMUM FROM THE EDGE OF THE DECK MEMBRANE.
3. APPROXIMATELY 1/8" (3 mm) DIAMETER BEAD OF CUT-EDGE SEALANT IS REQUIRED ON CUT EDGES OF FLEX TPO REINFORCED MEMBRANE.
4. REFER TO SPECIFICATION FOR ACCEPTABLE FLEX FASTENERS, PLATES AND OTHER FASTENING DENSITIES.