

MAX 24"

MIN. 8" HIGH

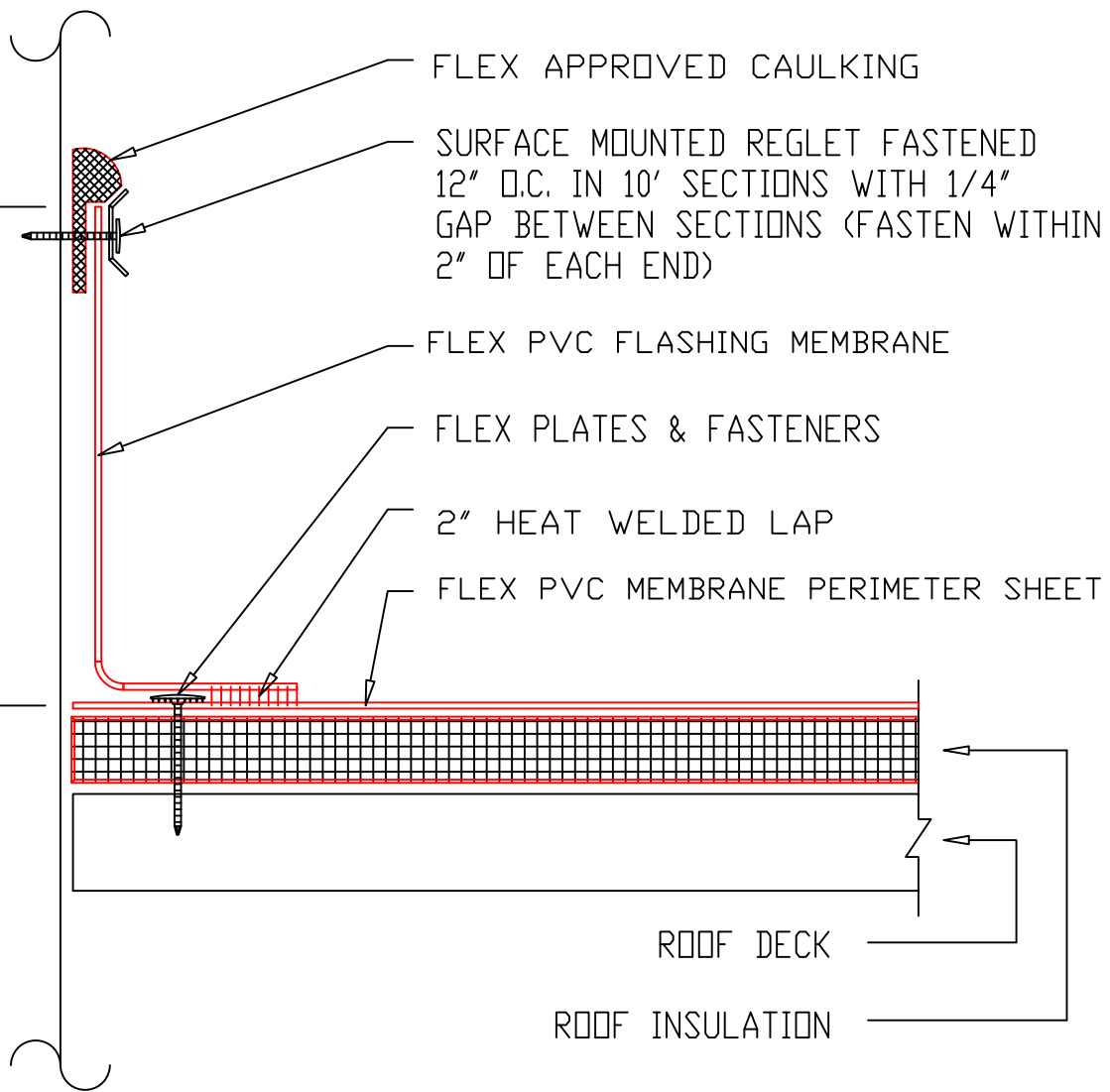

NOTES

REGLET SLIP JOINTS COVERS MUST BE USED WITH THE SURFACE MOUNTED REGLET

TITLE		WALL FLASHING SURFACE MOUNTED REGLET	
NAME		DETAIL NO. 2.10	
DRAWN BY:		DATE:	
KF		10/2009	
APPLICABLE TO ALL FLEX PVC			
MECHANICALLY FASTENED SYSTEMS			
FLEX MEMBRANE INTERNATIONAL		2670 LEISCZ'S BRIDGE RD.	LEESPORT, PA 19533
		800-969-0108	FlexRoofingSystems.com